

Quick Release Replacement Guide

Included in Kit

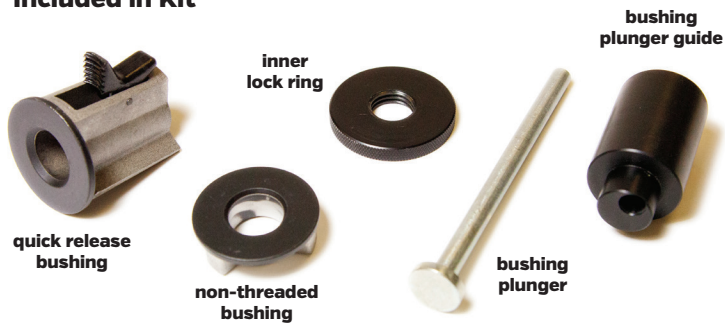

STEP 1

Watch installation video at:
<https://vimeo.com/118949750>
(or scan code at right)

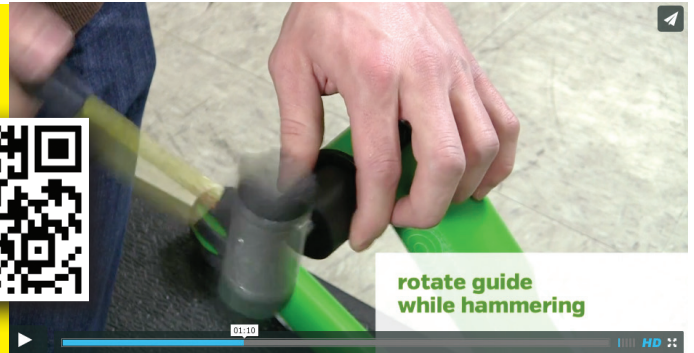

STEP 2

Thread out non-quick release rod



STEP 3

Using the 4mm hex key, remove the cone cup from threaded rod
Place the quick release lever up into the disengaged position and remove the threaded rod



STEP 4A

With the quick release lever still in the disengaged position, insert the bushing plunger into the quick release bushing from the left side until it drops into place between the quick release bushing and non-threaded bushing.



With the bushing plunger in place, insert the bushing plunger guide over the bushing plunger and into the left side of the quick release bushing.
Using the hammer, strike the exposed end of the bushing plunger while rotating the bushing plunger guide to evenly remove the right non-threaded bushing.



STEP 5

To prevent the quick release lever from impeding disassembly, flip the quick release lever to the inside of the quick release bushing and use duct tape or packing tape to cover the quick release lever slot.

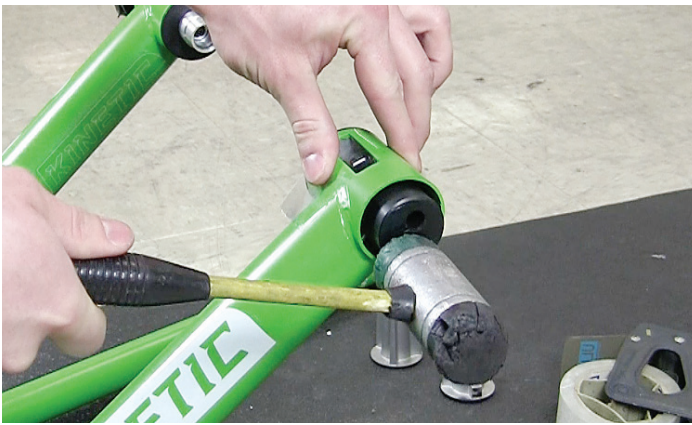

STEP 6

Once the non-threaded bushing is removed, insert the bushing plunger guide into the newly exposed right side of the quick release bushing

Using the hammer, strike the bushing plunger guide until the quick release bushing is removed from the left side of the slotted tube, discard the old quick release bushing.

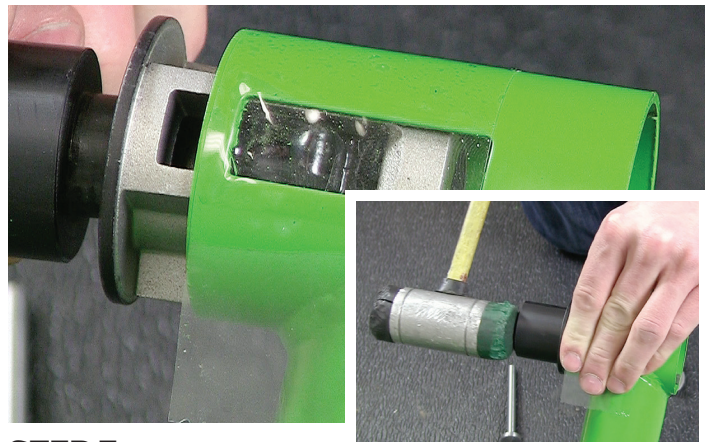

STEP 7

Install the new quick release bushing by lining up the scraped paint marks on the inside of the slotted tube with the quick release bushing fins and use the bushing plunger guide and hammer to strike the quick release bushing flush with the left side of the slotted tube.



STEP 8

Line up the scraped paint on the inside of the slotted tube with the non-threaded bushing and use the bushing plunger guide and hard face hammer to strike the non-threaded bushing flush with the right side of the slotted tube.



NOTE: if the threaded rod will not go through easily, tap handle lightly with the hammer to align it properly—then it should move freely.

STEP 9

Reinsert the threaded rod into the side of the slotted tube and install inner lock ring



STEP 10

Using the 4mm hex key, reattach the cone cup



USE INNER LOCK RING WHEN MOUNTING BIKE

Inner lock ring will prevent any quick release failures. Mount bike as you normally would. When fully secured, close inner lock ring until it's snug against the frame. There's no need to overtighten the inner lock ring.

